

# Gear Adaptor Feed Roll with bronze bush, black-finish, grinded

Applies for series: ME8700, ME8900, ME9800, ME9900

<p><b>Item number:</b> 74783</p> <p><b>Product weight (kg):</b> 0.03 kg</p> <p><b>Packing unit:</b> 1</p>	
<p><b>Gear</b> <b>Plain Bearing</b> <b>Polished</b> <b>Pin</b> <b>SWISS</b> <b>RoHS</b></p>	

## PRODUCT DESCRIPTION

Applies for series: ME8700, ME8900, ME9800, ME9900

## TECHNICAL CHARACTERISTICS

<b>Type of setting:</b>	Axle shaft gear adaptor
<b>Material:</b>	Hardened steel
<b>Surface:</b>	Black-finish
<b>Bearing:</b>	Bronze bush
<b>Feed Roll support:</b>	Grinded
<b>Driving pin type:</b>	Pin
<b>Concentricity:</b>	0.02

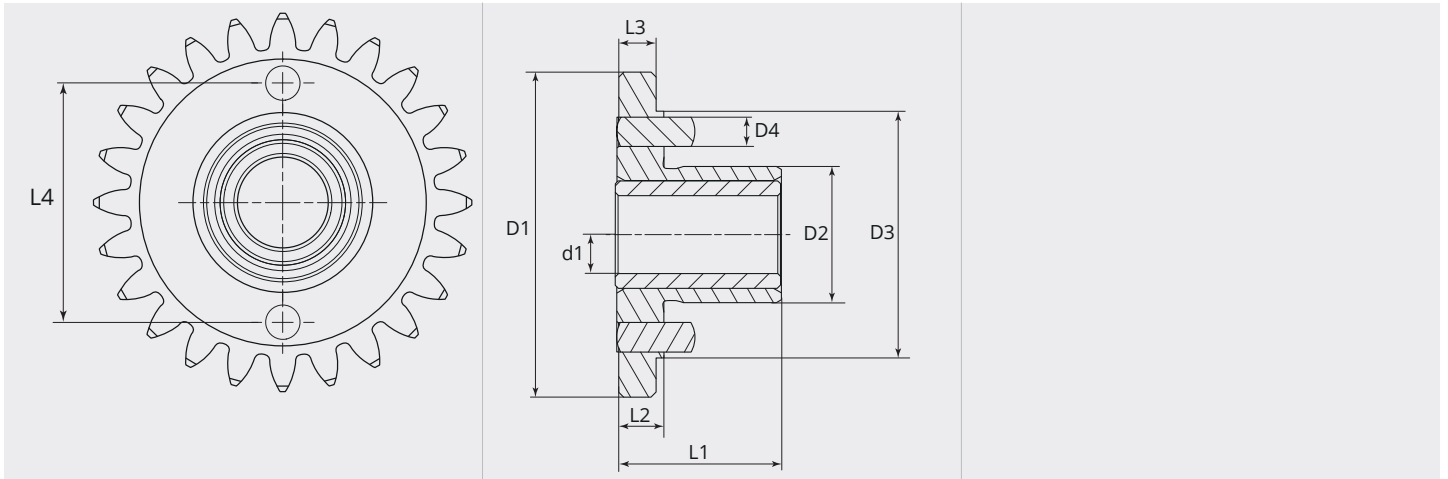
**DIMENSIONAL DRAWING**

**DIMENSIONAL DRAWING**

L1 (mm):	16.80
L2 (mm):	4.80
L3 (mm):	3.80
L4 (mm):	21.00
D1 (Ø):	33
D2 (Ø):	13.90
D3 (Ø):	25.20
D4 (Ø):	3.00
d1 (Ø):	8.00