

Gear Adaptor Feed Roll with needle bearing, black-finish, grinded

Applies for series: ME8700, ME8900, ME9800, ME9900

Item number:	62576
Product weight (kg):	0.029 kg
Packing unit:	1

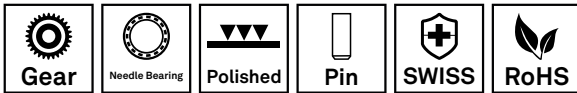

PRODUCT DESCRIPTION

Applies for series: ME8700, ME8900, ME9800, ME9900

TECHNICAL CHARACTERISTICS

Type of setting:	Axle shaft gear adaptor
Material:	Hardened steel
Surface:	Black-finish
Bearing:	Needle bearing
Feed Roll support:	Grinded
Driving pin type:	Pin
Concentricity:	0.05

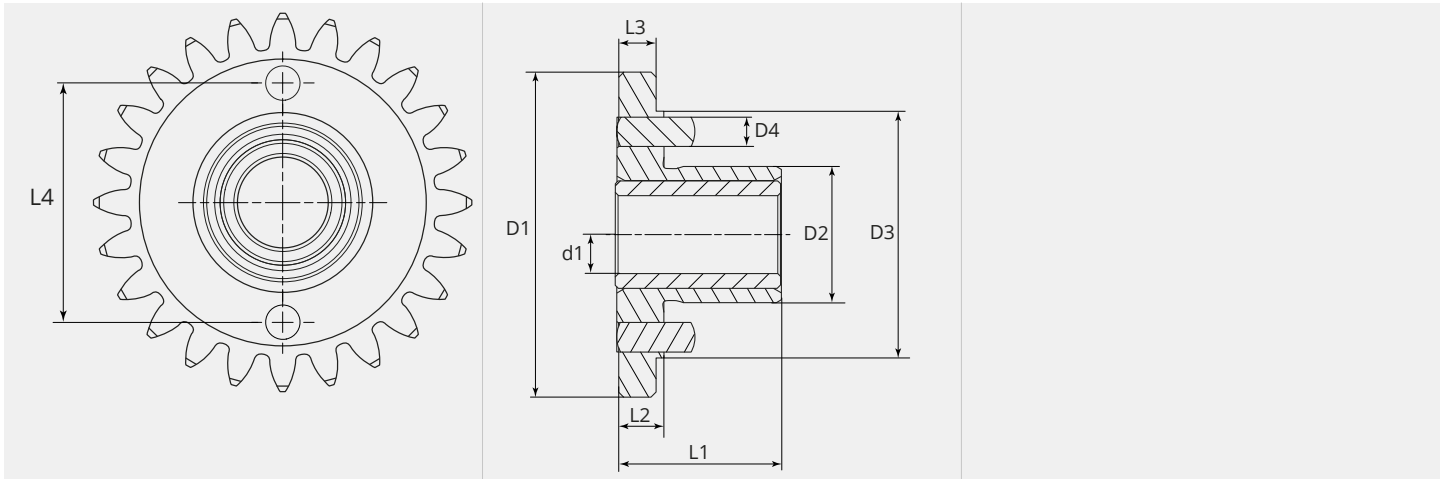
DIMENSIONAL DRAWING

DIMENSIONAL DRAWING

L1 (mm):	17.00
L2 (mm):	5.00
L3 (mm):	3.80
L4 (mm):	21.00
D1 (Ø):	33
D2 (Ø):	13.90
D3 (Ø):	25.20
D4 (Ø):	3.00
d1 (Ø):	8.00