

Gear Adaptor Feed Roll with bronze bush, black-finish, unpolished

Applies for series: ME9300, ME2000-37, ME2500-37, ME2600-37

Item number:	118211
Product weight (kg):	0.075 kg
Packing unit:	1



PRODUCT DESCRIPTION

Applies for series: ME9300, ME2000-37, ME2500-37, ME2600-37

TECHNICAL CHARACTERISTICS

Type of setting:	Axle shaft gear adaptor
Material:	Hardened steel
Surface:	Black-finish
Bearing:	Bronze bush
Feed Roll support:	Unpolished
Driving pin type:	Pin
Concentricity:	0.05

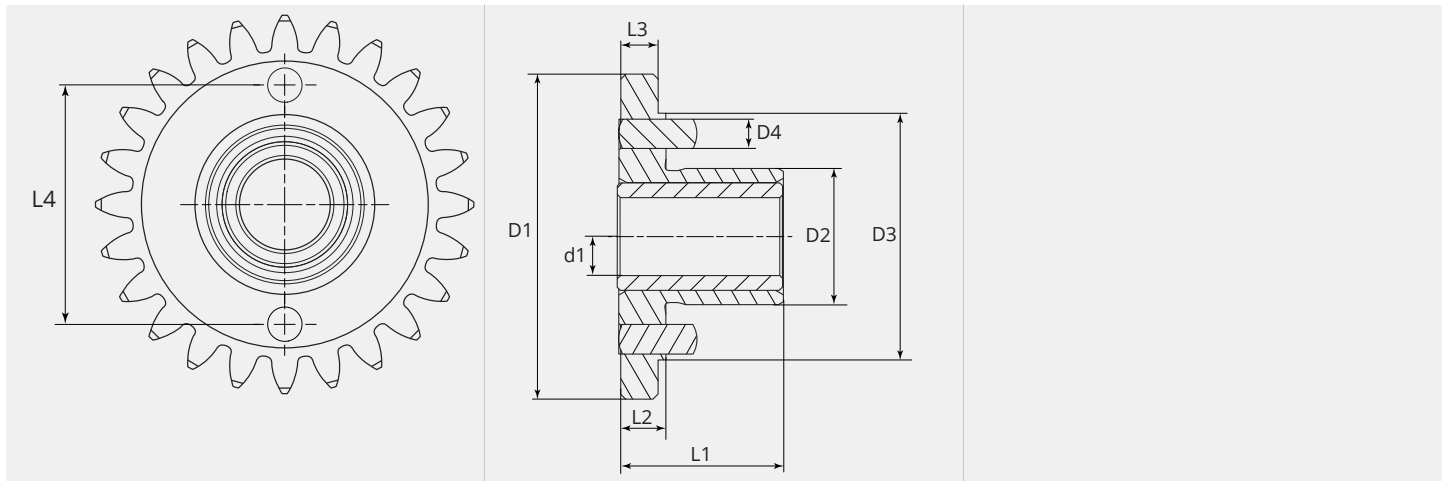
DIMENSIONAL DRAWING

DIMENSIONAL DRAWING

L1 (mm):	20.00
L2 (mm):	8.00
L3 (mm):	6.00
L4 (mm):	27.00
D1 (Ø):	40
D2 (Ø):	18.90
D3 (Ø):	32.00
D4 (Ø):	3.00
d1 (Ø):	8.00