

# Inlet guide tube synthetic for 1.6 - 2.0mm aluminium wire

Applies to Push-Pull

|                      |          |
|----------------------|----------|
| Item number:         | 116051   |
| Product weight (kg): | 0.006 kg |
| Packing unit:        | 1        |



## PRODUCT DESCRIPTION

Applies to Push-Pull

## TECHNICAL CHARACTERISTICS

|               |                 |
|---------------|-----------------|
| Wire (mm):    | 1.6 - 2.0       |
| Welding wire: | Aluminium       |
| Color code:   | red             |
| Material:     | Steel / plastic |
| Surface:      | Zinc plated     |
| Suitable:     | Push-Pull       |

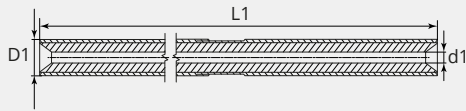
**DIMENSIONAL DRAWING****DIMENSIONAL DRAWING**

|                 |       |
|-----------------|-------|
| <b>L1 (mm):</b> | 109.5 |
| <b>D1 (Ø):</b>  | 4.9   |
| <b>d1 (Ø):</b>  | 2.5   |