

Gear Adaptor Feed Roll with needle bearing, nickel plated, grinded

Applies for series: ME2000-40, ME2500-40, ME2600-40

Item number:	115304
Product weight (kg):	0.086 kg
Packing unit:	1

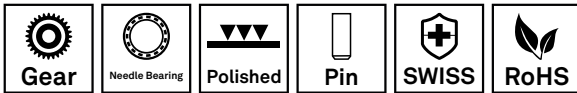

PRODUCT DESCRIPTION

Applies for series: ME2000-40, ME2500-40, ME2600-40

TECHNICAL CHARACTERISTICS

Type of setting:	Axle shaft gear adaptor
Material:	Hardened steel
Surface:	Electroless nickel
Bearing:	Needle bearing
Feed Roll support:	Grinded
Driving pin type:	Pin
Concentricity:	0.05

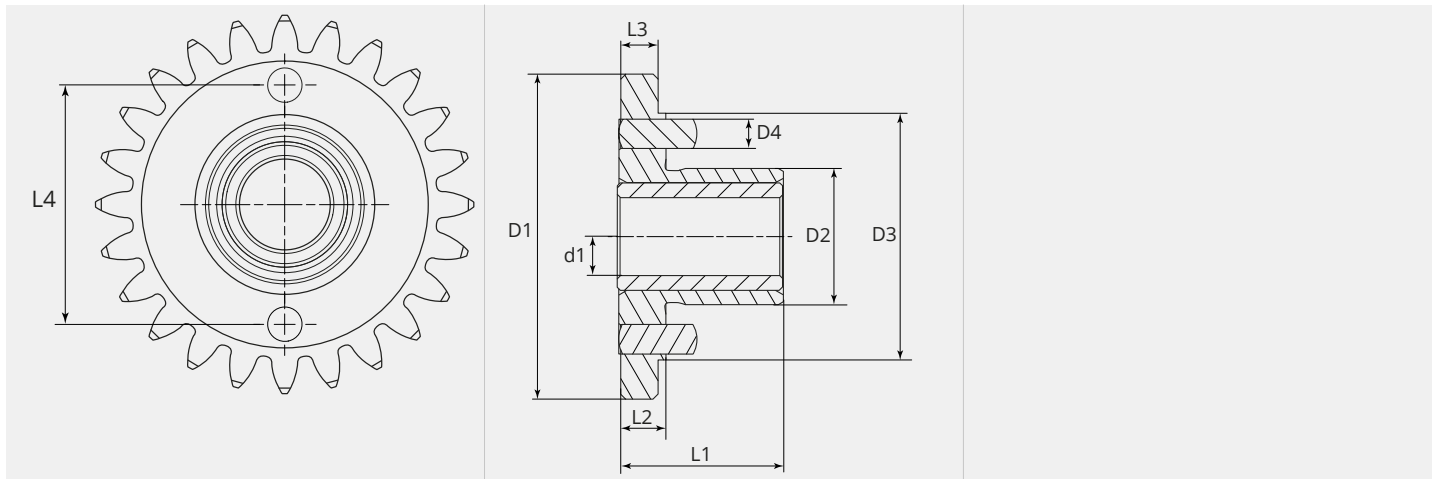
DIMENSIONAL DRAWING

DIMENSIONAL DRAWING

L1 (mm):	20.00
L2 (mm):	8.00
L3 (mm):	6.00
L4 (mm):	27.00
D1 (Ø):	43
D2 (Ø):	18.90
D3 (Ø):	34.00
D4 (Ø):	3.00
d1 (Ø):	8.00