

Gear Adaptor Feed Roll with bronze bush, nickel plated, grinded

Applies for series: ME9300, ME2000-37, ME2500-37, ME2600-37

| | |
|----------------------|----------|
| Item number: | 115209 |
| Product weight (kg): | 0.076 kg |
| Packing unit: | 1 |

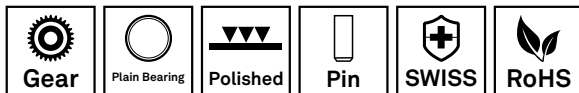

PRODUCT DESCRIPTION

Applies for series: ME9300, ME2000-37, ME2500-37, ME2600-37

TECHNICAL CHARACTERISTICS

| | |
|--------------------|-------------------------|
| Type of setting: | Axle shaft gear adaptor |
| Material: | Hardened steel |
| Surface: | Electroless nickel |
| Bearing: | Bronze bush |
| Feed Roll support: | Grinded |
| Driving pin type: | Pin |
| Concentricity: | 0.02 |

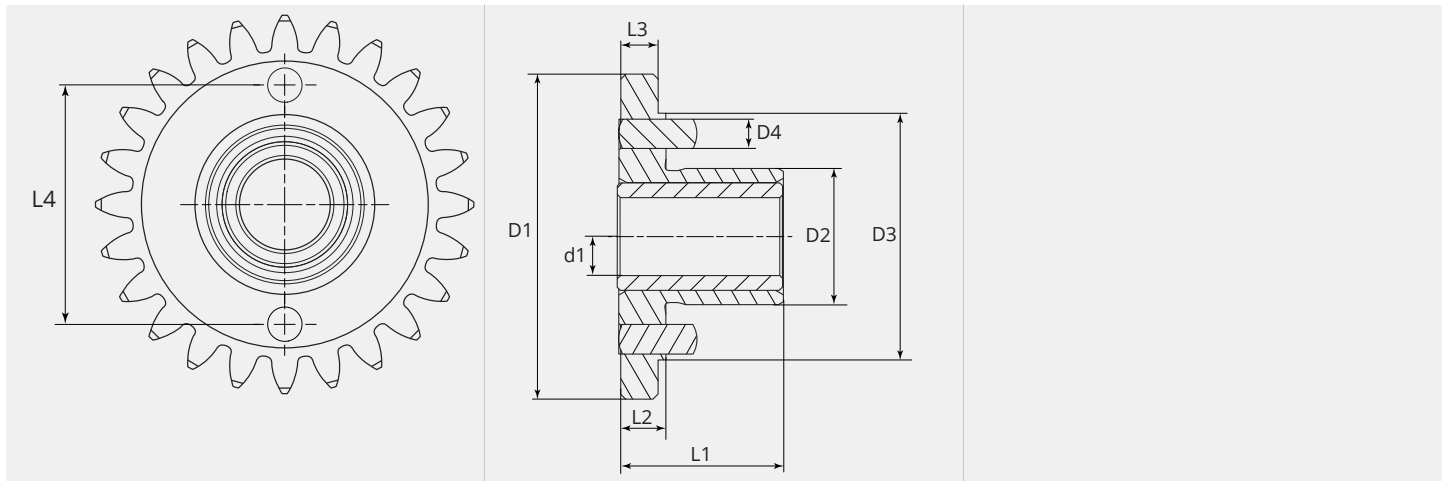
DIMENSIONAL DRAWING

DIMENSIONAL DRAWING

| | |
|----------|-------|
| L1 (mm): | 20.00 |
| L2 (mm): | 8.00 |
| L3 (mm): | 6.00 |
| L4 (mm): | 27.00 |
| D1 (Ø): | 40 |
| D2 (Ø): | 18.90 |
| D3 (Ø): | 32.00 |
| D4 (Ø): | 3.00 |
| d1 (Ø): | 8.00 |