

# Main Gear Drive isolated, nickel plated

Applies for series: ME8900, ME9900-4R

|                      |          |
|----------------------|----------|
| Item number:         | 115203   |
| Product weight (kg): | 0.041 kg |
| Packing unit:        | 1        |

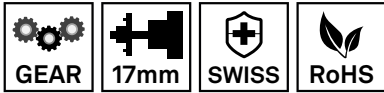

## PRODUCT DESCRIPTION

Applies for series: ME8900, ME9900-4R

## TECHNICAL CHARACTERISTICS

|                                  |   |
|----------------------------------|---|
| <b>Type of setting:</b>          | Motor shaft isolated                          |
| <b>Material:</b>                 | Hardened steel                                |
| <b>Surface:</b>                  | Electroless nickel                            |
| <b>Isolated:</b>                 | yes   |
| <b>Feed Roll support:</b>        | insulated                                     |
| <b>Motor/gear distance (mm):</b> | 17  |
| <b>Driving pin type:</b>         | W/O   |
| <b>Specifics:</b>                | Suitable for insulating disc 14.8mm thickness |
| <b>Motor positions:</b>          | in the centre                                 |

## DIMENSIONAL DRAWING

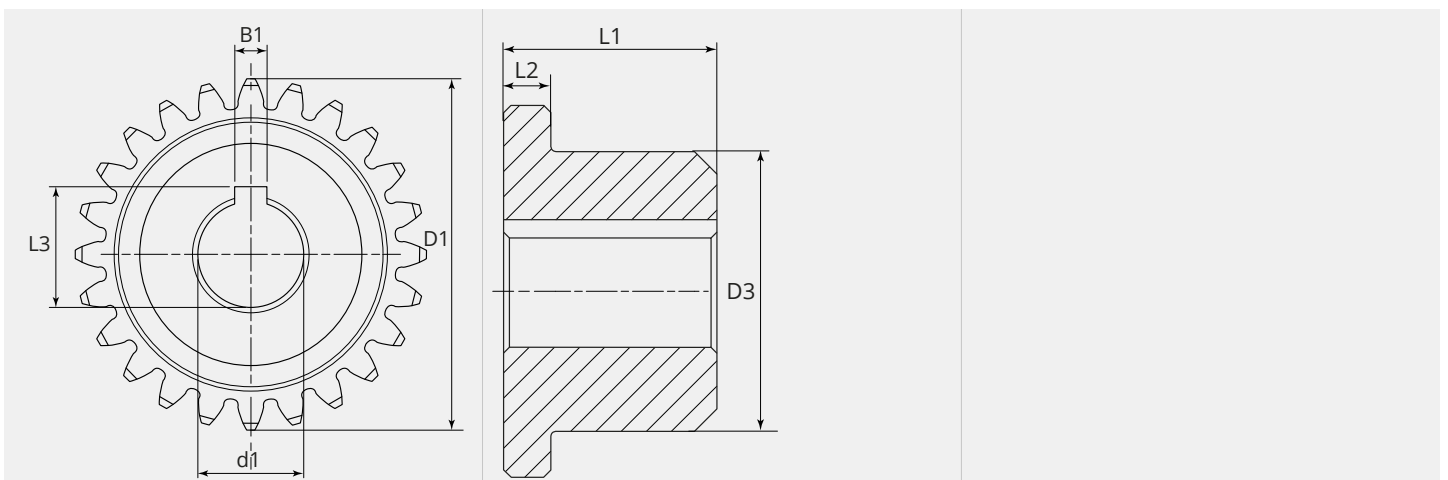



**DIMENSIONAL DRAWING**

|                 |       |
|-----------------|-------|
| <b>L1 (mm):</b> | 19.00 |
| <b>L2 (mm):</b> | 4.20  |
| <b>L3 (mm):</b> | 12.60 |
| <b>B1 (mm):</b> | 3.00  |
| <b>D1 (Ø):</b>  | 33.2  |
| <b>D3 (Ø):</b>  | 25.00 |
| <b>d1 (Ø):</b>  | 10.00 |