

# Inlet guide tube ID3.0x109.5

Applies to Push-Pull

Item number:	114305
Product weight (kg):	0.011 kg
Packing unit:	1



## PRODUCT DESCRIPTION

Applies to Push-Pull

## TECHNICAL CHARACTERISTICS

Wire (mm):	2.0 - 2.5
Welding wire:	Steel / cored wire
Material:	Steel
Surface:	Zinc plated
Suitable:	Push-Pull

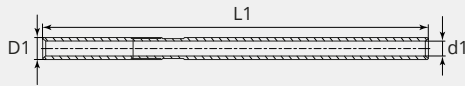
**DIMENSIONAL DRAWING****DIMENSIONAL DRAWING**

<b>L1 (mm):</b>	109.5
<b>D1 (Ø):</b>	4.9
<b>d1 (Ø):</b>	3.0