

Inlet guide tube ID2.5x109.5

Applies to Push-Pull

Item number:	114304
Product weight (kg):	0.013 kg
Packing unit:	1



PRODUCT DESCRIPTION

Applies to Push-Pull

TECHNICAL CHARACTERISTICS

Wire (mm):	1.4 - 2.0
Welding wire:	Steel / cored wire
Material:	Steel
Surface:	Zinc plated
Suitable:	Push-Pull

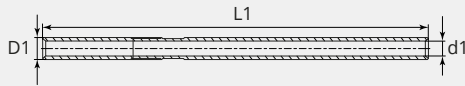
DIMENSIONAL DRAWING**DIMENSIONAL DRAWING**

L1 (mm):	109.5
D1 (Ø):	4.9
d1 (Ø):	2.5