

Gear Adaptor Feed Roll with bronze bush, nickel plated

Applies for series: Push-Pull and MEXDRIVE

Item number: 114242
 Product weight (kg): 0.016 kg



PRODUCT DESCRIPTION

Applies for series: Push-Pull and MEXDRIVE

TECHNICAL CHARACTERISTICS

Type of setting:	Axle shaft gear adaptor
Material:	Hardened steel
Surface:	Electroless nickel
Bearing:	Bronze bush
Driving pin type:	Pin
Concentricity:	0.05

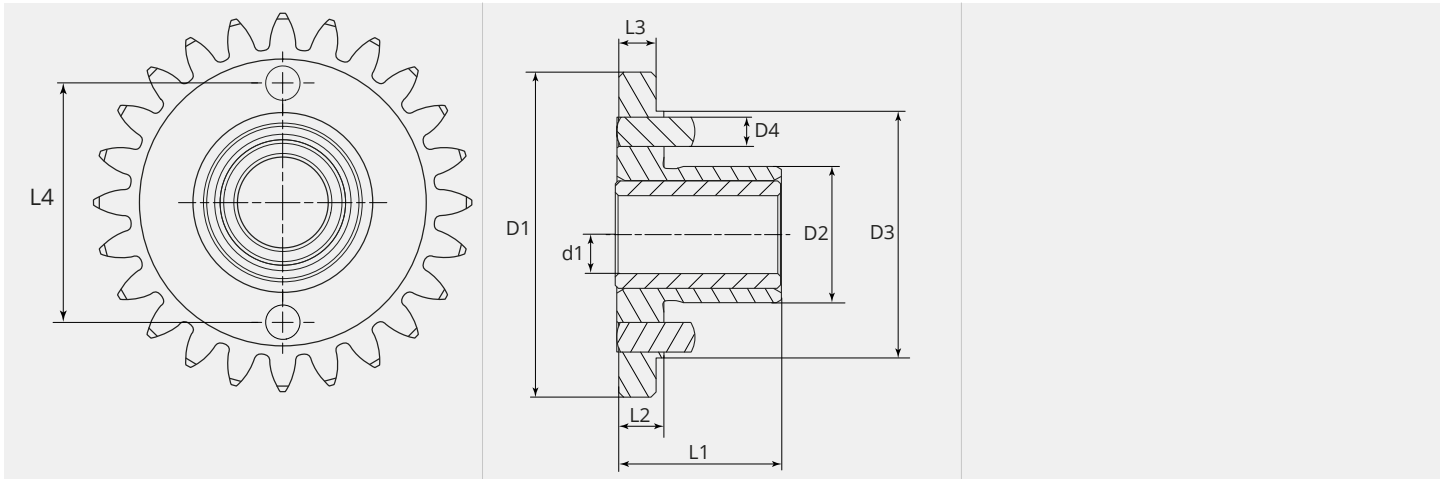
DIMENSIONAL DRAWING

DIMENSIONAL DRAWING

L1 (mm):	9.60
L2 (mm):	4.60
L3 (mm):	4.30
L4 (mm):	13.50
D1 (Ø):	25.7
D2 (Ø):	13.50
D3 (Ø):	17.00
D4 (Ø):	2.50
d1 (Ø):	6.00