

Gear Adaptor Feed Roll with needle bearing, black-finish, grinded

Applies for series: ME2000-40, ME2500-40, ME2600-40

| | |
|----------------------|----------|
| Item number: | 105004 |
| Product weight (kg): | 0.085 kg |
| Packing unit: | 1 |

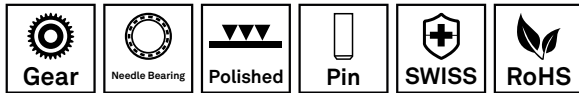

PRODUCT DESCRIPTION

Applies for series: ME2000-40, ME2500-40, ME2600-40

TECHNICAL CHARACTERISTICS

| | |
|--------------------|-------------------------|
| Type of setting: | Axle shaft gear adaptor |
| Material: | Hardened steel |
| Surface: | Black-finish |
| Bearing: | Needle bearing |
| Feed Roll support: | Grinded |
| Driving pin type: | Pin |
| Concentricity: | 0.05 |

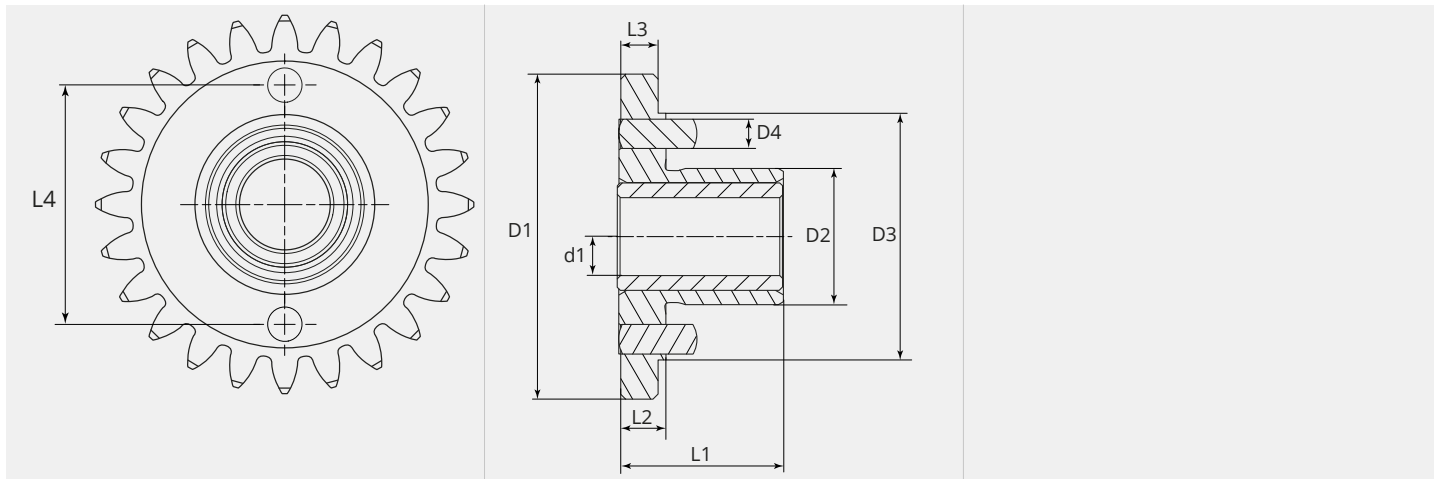
DIMENSIONAL DRAWING

DIMENSIONAL DRAWING

| | |
|----------|-------|
| L1 (mm): | 20.00 |
| L2 (mm): | 8.00 |
| L3 (mm): | 6.00 |
| L4 (mm): | 27.00 |
| D1 (Ø): | 43 |
| D2 (Ø): | 18.90 |
| D3 (Ø): | 34.00 |
| D4 (Ø): | 3.00 |
| d1 (Ø): | 8.00 |