

# Euro Central Adaptor torch side with two fixed pins

Applies for water cooled MIG/MAG Torch

Item number:	100376
Product weight (kg):	0.18 kg
Packing unit:	1



## PRODUCT DESCRIPTION

Applies for water cooled MIG/MAG Torch

## TECHNICAL CHARACTERISTICS

Version:	Round
Number of contact pins:	2
Pin type:	fixed
Cooling:	Water
Terminal side:	Welding torch
Hose package Connection:	Euro
Material:	Brass

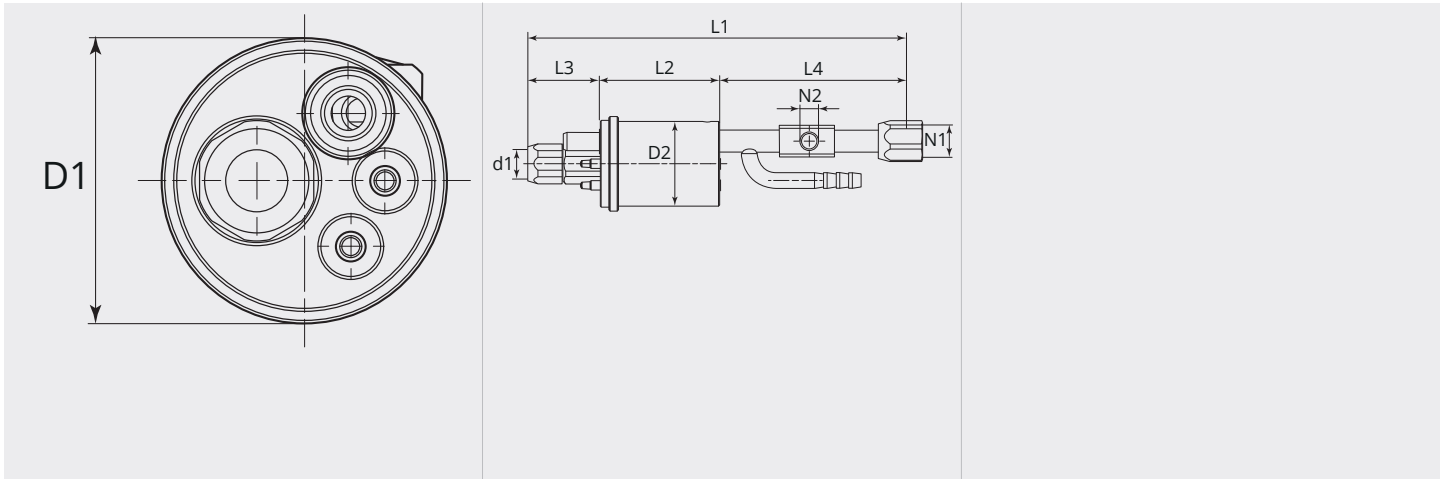
**DIMENSIONAL DRAWING**

**DIMENSIONAL DRAWING**

L1 (mm):	117.6
L2 (mm):	38.0
L3 (mm):	21.6
L4 (mm):	58.5
D1 (Ø):	30
D2 (Ø):	26.9
d1 (Ø):	6.5
N1:	M10x1
N2:	M6