



ME352WSC WATER SUPER-COOLED WELDING TORCHES MIG/MAG 350 Amp.



These torches are characterized by the following features:

- Ergonomic and technically advanced, 100% reliable
- Globally recognized using top quality
- New ergonomically shaped handles for best accessibility and fatigue-free work
- Handle with ball joint for motion flexibility - excellent handling
- Optimal torch cooling over long periods
- Best ignition even with thin wires
- Versatility due to the Euro Central Adapter System
- Different handles available upon request
- Swan Neck in 180° / 60° / 45°

Model	ME352WSC
Maximum current CO ₂	350 A
Duty Cycle CO ₂	80%
Maximum current Argon R.G.M.	270 A
Duty Cycle Argon	80%
Wire Ø	0.8 - 2.0 mm

Type	Item no. - 3.0m	Item no. - 3.5m	Item no. - 4.0m	Item no. - 4.5m
ME352WSC-N Spring Pins	116767	116768	116769	116770

Different lengths available upon request

Replacement Parts:

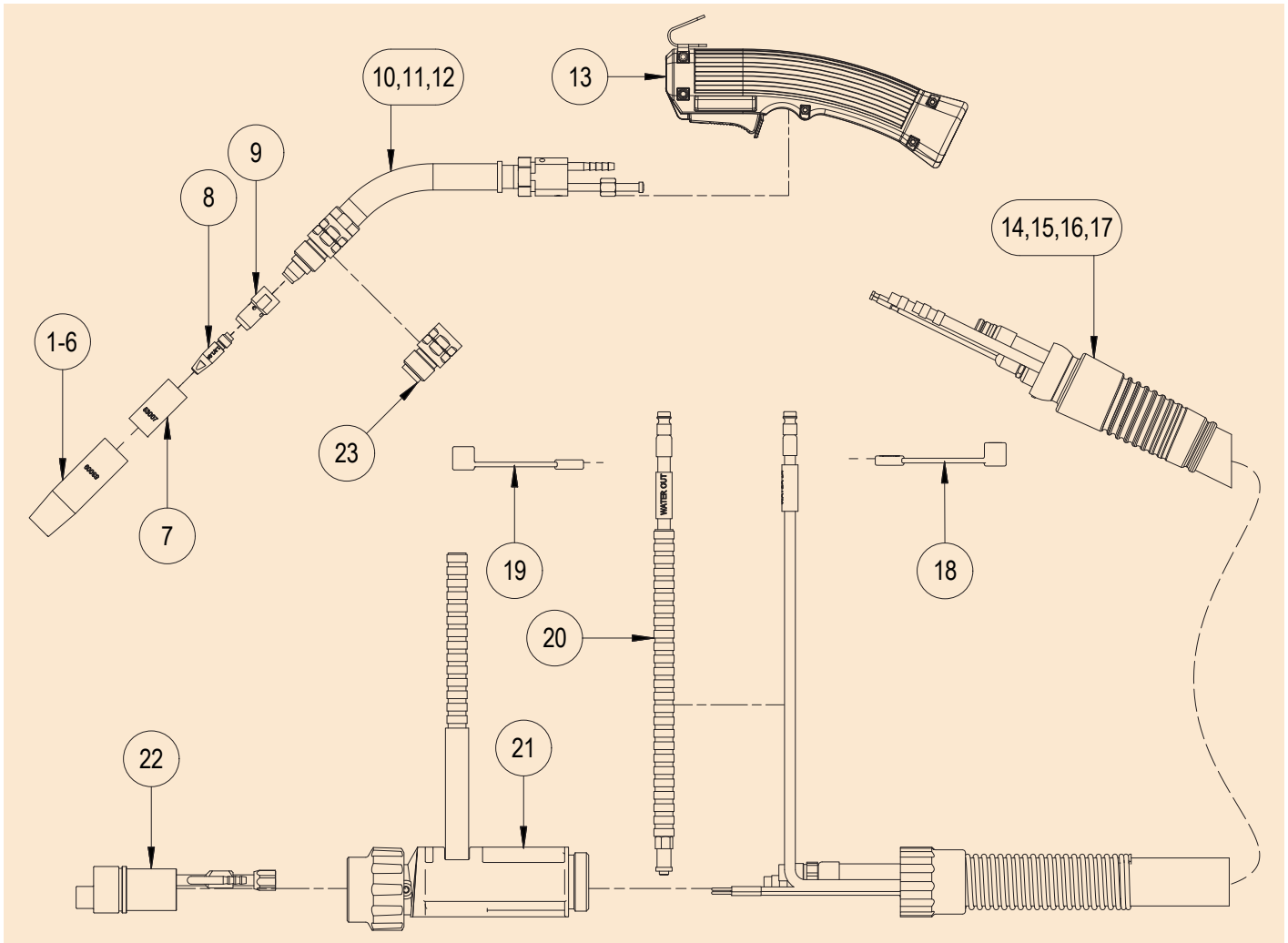

Pos.	Item no.	Description	psc.
1	53009	Nozzle spray HD	1
2	53004	Nozzle dip, long conical	1
2a	53157	Nozzle dip, long conical *	1
3	53003	Nozzle dip, short conical	1
3a	53156	Nozzle dip, short conical *	1
4	53015	Nozzle spray HD short	1
5	53005	Nozzle parallel	1
6	53006	Nozzle spot	1
7	53001	Nozzle insulator Ø 16.9 x 14.5 L = 36	5
8	57838	Contact tip M8 copsil 1.0 / 0.8 aluminium round	10
9	53311	Gas diffuser M8 ME352 WSC	5
10	53300	Swan neck ME352WSC 45° complete	1
11	53301	Swan neck ME352WSC 60° complete	1
12	53302	Swan neck ME352WSC 180° straight	1
13 ¹	117692	Handle kit size 1-3 with ball joint	1

Pos.	Item no.	Description	psc.
14	116980	Hose cable assembly 352WSC, spring pins, ball joint, 3.0m	1
15	116981	Hose cable assembly 352WSC, spring pins, ball joint, 3.5m	1
16	116982	Hose cable assembly 352WSC, spring pins, ball joint, 4.0m	1
17	116983	Hose cable assembly 352WSC, spring pins, ball joint, 4.5m	1
18	115822	Water cap, blue	1
19	115823	Water cap, red	1
20	76054	Water outlet hose compl.	1
21	117695	Central adapter support, water cooled, kit	1
22	57341	2-pin central adapter M12 x 1. compl. spring pins	1
23	53315	Service kit swan neck ME352 WSC + MER352 WSC	1

¹ = for other handle kits refer to data sheet: Handle kits

* no plating

Gas Diffuser

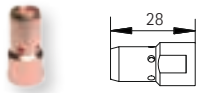

53311 M8

Liners Hard Wire



- 57195 - 3.0m 0.8 - 1.2 blue, steel wire
- 57196 - 3.5m 0.8 - 1.2 blue, steel wire
- 57197 - 4.0m 0.8 - 1.2 blue, steel wire
- 57198 - 4.5m 0.8 - 1.2 blue, steel wire
- 57261 - 3.0m 1.4 - 2.0 red, steel wire
- 57262 - 3.5m 1.4 - 2.0 red, steel wire
- 57263 - 4.0m 1.4 - 2.0 red, steel wire
- 57264 - 4.5m 1.4 - 2.0 red, steel wire

- 57281 - 3.0m 1.2 - 1.4 grey, steel wire
- 57282 - 3.5m 1.2 - 1.4 grey, steel wire
- 57283 - 4.0m 1.2 - 1.4 grey, steel wire
- 57284 - 4.5m 1.2 - 1.4 grey, steel wire

Liners Soft Wire



- 57155 - 3.0m 0.8 - 1.0 black, aluminium wire
- 57156 - 3.5m 0.8 - 1.0 black, aluminium wire
- 57157 - 4.0m 0.8 - 1.0 black, aluminium wire
- 57158 - 4.5m 0.8 - 1.0 black, aluminium wire
- 57250 - 3.0m 1.2 - 2.0 red, aluminium wire
- 57251 - 3.5m 1.2 - 2.0 red, aluminium wire
- 57252 - 4.0m 1.2 - 2.0 red, aluminium wire
- 57253 - 4.5m 1.2 - 2.0 red, aluminium wire

- 57200 - 3.0m 1.0 - 1.2 blue, aluminium wire
- 57201 - 3.5m 1.0 - 1.2 blue, aluminium wire
- 57202 - 4.0m 1.0 - 1.2 blue, aluminium wire
- 57203 - 4.5m 1.0 - 1.2 blue, aluminium wire

Type

Contact Tips



Contact Tip M8 hexagonal (pure copper)
MOQ = 10 pcs.

- 57800 - M8 0.8 hexagonal
- 57801 - M8 0.9 hexagonal
- 57802 - M8 1.0 / 0.8 aluminium hexagonal
- 57803 - M8 1.2 / 1.0 aluminium hexagonal
- 57804 - M8 1.4 / 1.2 aluminium hexagonal
- 57805 - M8 1.6 / 1.4 aluminium hexagonal
- 57834 - M8 1.8 / 1.6 aluminium hexagonal
- 57806 - M8 2.0 / 1.8 aluminium hexagonal

Contact Tip M8 round, copsil (copper-silver)
MOQ = 10 pcs.

- 57835 - M8 copsil 0.8 round
- 57836 - M8 copsil 0.9 round
- 57837 - M8 copsil 1.0 / 0.8 aluminium round
- 57838 - M8 copsil 1.2 / 1.0 aluminium round
- 57839 - M8 copsil 1.4 / 1.2 aluminium round
- 57840 - M8 copsil 1.6 / 1.4 aluminium round
-
- 57841 - M8 copsil 2.0 / 1.8 aluminium round

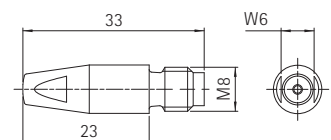
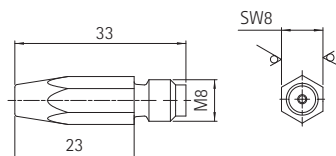

	Pos.	Item no.	Description
	1	53009	Nozzle spray HD
	2	53004	Nozzle dip, long conical
	2a	53157	Nozzle dip, long conical *
	3	53003	Nozzle dip, short conical
	3a	53156	Nozzle dip, short conical *
	4	53015	Nozzle spray HD short
	5	53005	Nozzle parallel
	6	53006	Nozzle spot

* no plating